

Important note about MacBook's using a USB Ethernet adaptor

- MOST USB Ethernet adaptors are NOT plug and play.
- You must first install the drivers for your USB Ethernet adaptor in order for it to work as a wired connection on your computer.
- Drives can be found on the manufacturer's website, along with instructions for installation
- After installing the drivers for you USB Ethernet adaptor, you can follow the instructions listed below

Locating the Wired & Wireless MAC Address for your Mac

1. Open the System Preferences

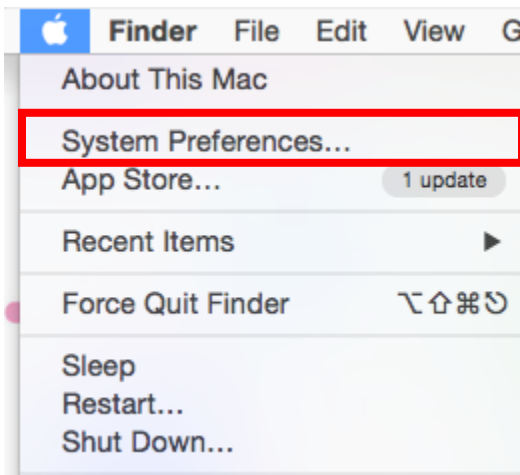

2. Click Network

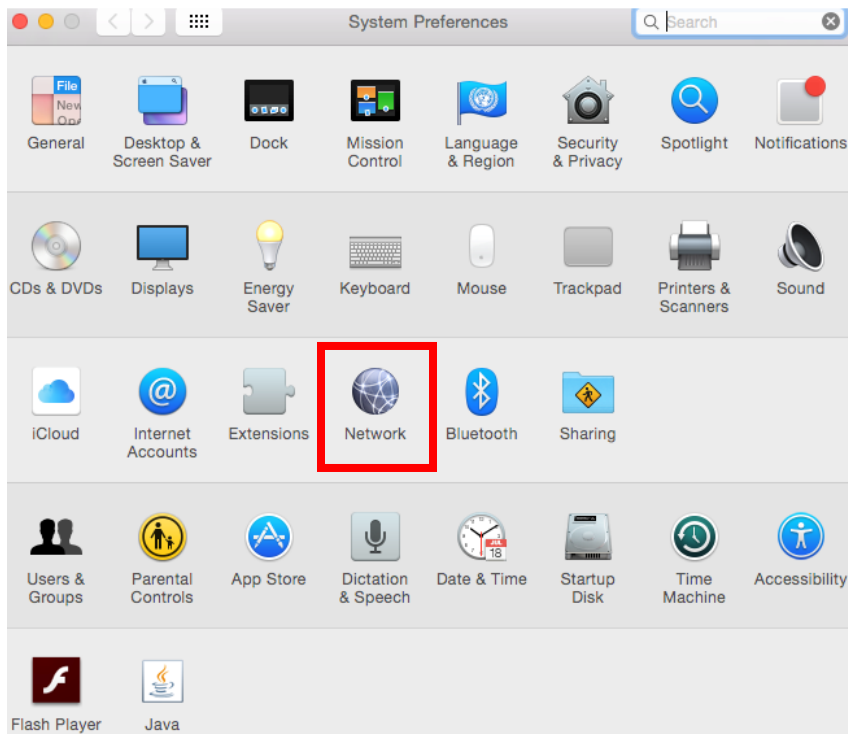

3. Choose your desired connection – Wired/Ethernet or Wireless/Wi-Fi – then click Advanced

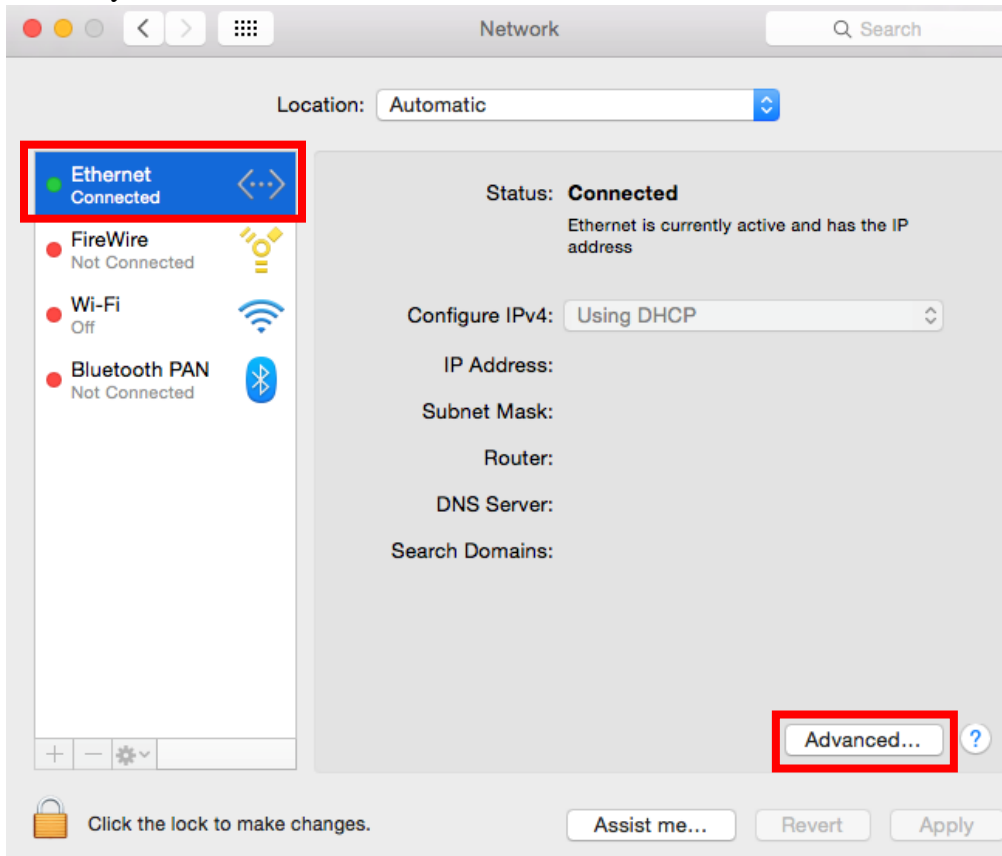

4. From the next screen click the Hardware tab.

